

| PRODUCT NO.  | PLATING PERFORMANCE LEVEL | FOR REAR PLUG-UP APPLICATIONS USE SHROUD |
|--------------|---------------------------|------------------------------------------|
| 73983-1ZZZ   | TELCORDIA CO              | 84818-101                                |
| 73983-1ZZZLF |                           | 84818-101LF                              |
| 73983-2ZZZ   | CUSTOMER SPECIAL          | 84818-301                                |
| 73983-2ZZZLF |                           | 84818-301LF                              |
| 73983-3ZZZ   | CUSTOMER SPECIAL          | 84818-301                                |
| 73983-3ZZZLF |                           | 84818-301LF                              |
| 73983-5ZZZ   | TELCORDIA UE              | 84818-501                                |
| 73983-5ZZZLF |                           | 84818-501LF                              |
| 73983-9ZZZ   | TELCORDIA CO              | 84818-101                                |
| 73983-9ZZZLF |                           | 84818-101LF                              |

EYE OF NEEDLE PRESS FIT SECTION      BABY-H PRESS FIT SECTION

DETAIL A  
SCALE 4:1  
SEE NOTE 15

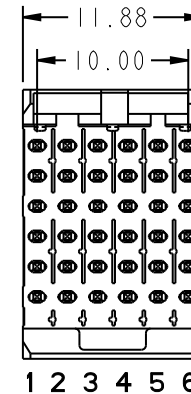
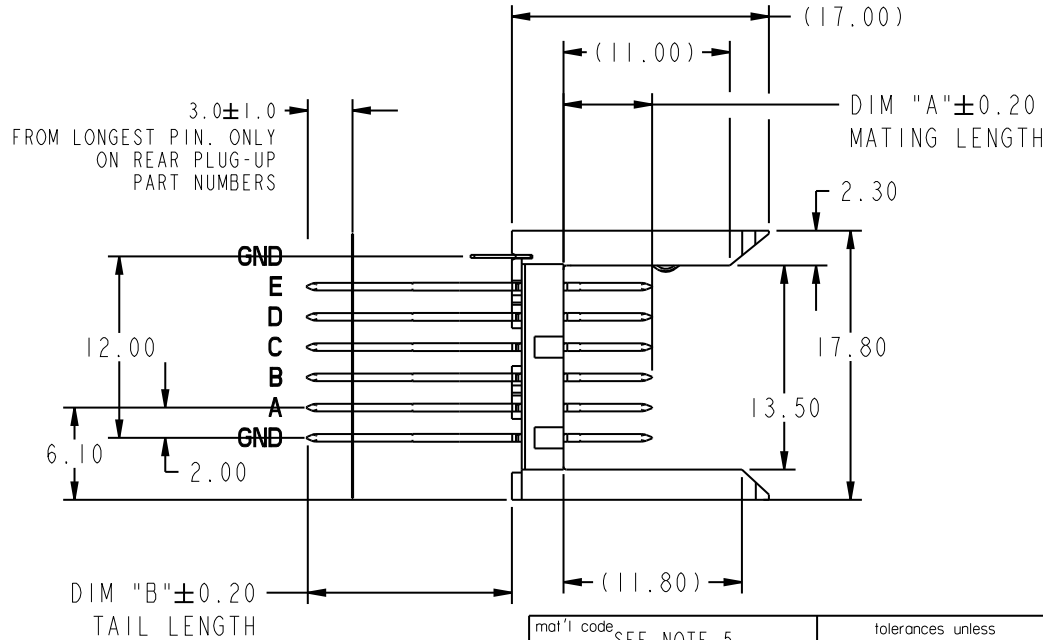
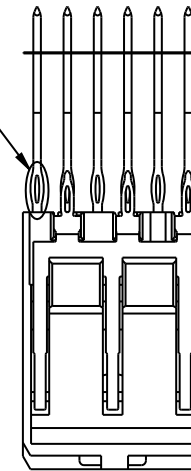

|                       |                |     |            |                                       |               |            |            |                                 |             |        |     |
|-----------------------|----------------|-----|------------|---------------------------------------|---------------|------------|------------|---------------------------------|-------------|--------|-----|
| mat'l code SEE NOTE 5 |                |     |            | tolerances unless otherwise specified |               |            | CUSTOMER   | FCJ                             |             |        |     |
| ltr                   | ecr no.        | dr  | date       | linear                                |               |            | COPY       | www.fciconnect.com              |             |        |     |
| T                     | V06-0544       | DCH | 2006-06-09 |                                       |               |            | projection | title VERTICAL SIGNAL HDR 5 ROW |             |        |     |
| U                     | V07-0165       | DCH | 2007-03-14 |                                       |               |            |            | P.F. 30 POS. SPECIAL LOAD STD.  |             |        |     |
| V                     | V07-0667       | HTB | 2007-11-07 | angles                                |               |            |            | product family                  | METRAL 1000 | code   |     |
| W                     | V08-0009       | LP  | 2008-1-23  | dr                                    | K. BELL       | 2000-03-29 | MM         | size                            | dwg no      |        |     |
| X                     | 109-0254       | RKV | 2009-11-13 | engr                                  | M. HAHN       | 2000-03-29 |            | A                               | 73983       |        |     |
| R                     | V04-0398       | DAI | 2004-05-25 | chr                                   | RAJKRISHNAN.V | 2009-11-13 |            |                                 |             | sheet  | 213 |
| S                     | V05-0405       | DAI | 2005-05-16 | appd                                  | BIJU K PAUL   | 2009-11-13 |            |                                 |             | 1 of 6 |     |
| sheet index           | revision sheet | X   | X          | X                                     | X             | X          | X          | cage code                       |             |        |     |
|                       |                | 1   | 2          | 3                                     | 4             | 5          | 6          | 22526                           |             |        |     |

This document is the property of and embodies CONFIDENTIAL and PROPRIETARY information of FCJ. No part of the information shown on this document may be used in any way or disclosed to others without the written consent of FCJ. Copyright FCJ.

PRODUCT NUMBER  
SEE TABLE

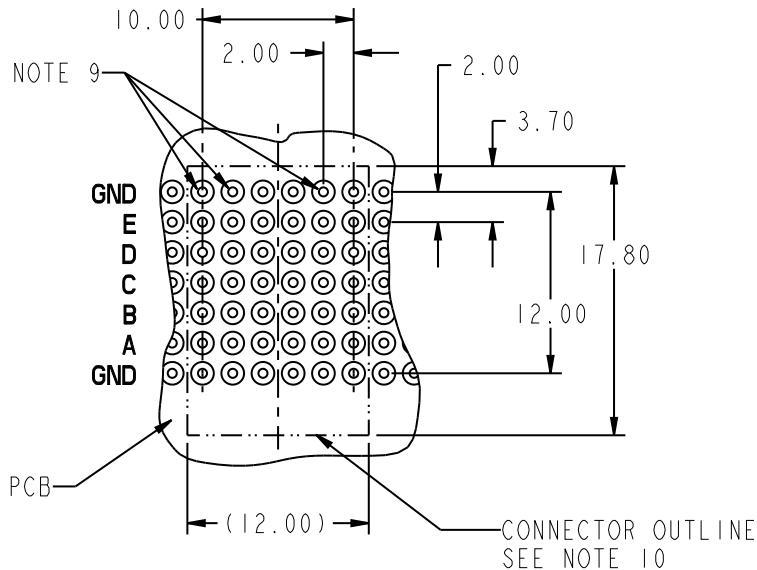

RECOMMENDED PCB HOLE PATTERN  
(COMPONENT SIDE)

NOTES:

- SEE APPLICATION SPECIFICATION GS-20-010 FOR INFORMATION ON AVAILABLE TOOLING, CIRCUIT BOARD DESIGN CONSIDERATIONS, REPAIR PROCEDURES AND PRODUCT OFFERINGS.
- SEE FCI PUBLICATION 950511-028 FOR "ELECTRICAL PERFORMANCE DATA FOR DIFFERENTIAL APPLICATIONS."
- SEE FCI PUBLICATION 950511-029 FOR "ELECTRICAL PERFORMANCE DATA FOR SINGLE-ENDED APPLICATION."
- UNLESS OTHERWISE SPECIFIED, ALL DIMENSIONS AND TOLERANCES ARE IN ACCORDANCE WITH ASME Y14.5, 1994
- HOUSING MATERIAL: LIQUID CRYSTAL POLYMER, 30% GLASS FILLED, FLAME RETARDANT PER UL 94-V0.  
PIN MATERIAL: PHOSPHER BRONZE  
GROUND SPRING MATERIAL: PHOSPHER BRONZE
- PLATING INFORMATION: PLATING ON CONTACT AREAS IS PER PERFORMANCE LEVELS SHOWN IN TABLE ON SHEET I. PLATING ON "LF" TAILS IS Sn. PLATING ON ALL OTHER TAILS IS SnPb.
- DIMENSIONAL RESTRICTIONS OF PINS IN HEADERS.  
FOR MATING WITH METRAL 1000 RECEPTACLES  
DIM A : 5.00mm MIN, 8.00mm MAX FOR ROWS A-E  
DIM A : 5.00mm MIN, 5.75mm MAX FOR ROW GND NEXT TO ROW A  
DIM C : 5.00mm MIN, 8.00mm MAX FOR ROWS A-E  
DIM C : 4.60mm MIN, 6.30mm MAX FOR ROW GND NEXT TO ROW A  
FOR MATING WITH METRAL 4000 RECEPTACLES  
DIM A : 5.00mm MIN, 6.50mm MAX FOR ROWS A, B, D & E  
DIM A : 5.00mm MIN, 8.00mm MAX FOR ROW C  
DIM A : 5.00mm MIN, 5.75mm MAX FOR ROW GND NEXT TO ROW A  
DIM C : 5.00mm MIN, 7.00mm MAX FOR ROWS A, B, D & E  
DIM C : 5.00mm MIN, 8.00mm MAX FOR ROW C  
DIM C : 4.60mm MIN, 6.30mm MAX FOR ROW GND NEXT TO ROW A
- THE MIN PCB THICKNESS FOR REAR PLUG-UP APPLICATIONS IS 2.9mm SINCE THE COMPLAINT SECTIONS OF THE GROUND SPRING OF THE HEADER DIRECTLY OPPOSE THE GROUND SPRING OF THE SHROUD. THE MIN PCB THICKNESS FOR FRONT PLUG-UP ONLY APPLICATIONS IS 1.6mm.
- THESE HOLES ARE NEEDED FOR REAR PLUG-UP DESIGNS USING A SHROUD AND MAY BE OMITTED FOR FRONT PLUG-UP ONLY DESIGNS.
- THE "CONNECTOR OUTLINE" IS THE MIN OUTLINE REQUIRED. TO DETERMINE THE OUTLINE NECESSARY TO PERMIT THE VARIOUS TYPES OF REPAIR OPERATIONS, SEE APPLICATION SPECIFICATION GS-20-010.
- CURRENT RATING: 1 AMP PER PIN
- TEMPERATURE RANGE: -55°C TO +105°C
- THE PRODUCTS WHERE THE PART NUMBER ENDS IN LF MEET EUROPEAN UNION DIRECTIVES AND OTHER COUNTRY REGULATIONS AS DESCRIBED IN GS-22-008. ALL PRODUCTS WILL WITHSTAND EXPOSURE TO 260°C FOR 60 SECONDS IN A CONVECTION, INFRA-RED OR VAPOR PHASE REFLOW OVEN.
- FOR LEAD FREE PART NUMBERS, ADD 'LF' SUFFIX. EXAMPLE: 73983-XXXXLF
- PIN TYPE IS AT THE MANUFACTURERS OPTION AND CAN BE EITHER BABY-H OR EYE OF THE NEEDLE STYLE

| PRESS-FIT HOLES             | OPTION 1                  |
|-----------------------------|---------------------------|
| HOLE DIAMETER AFTER PLATING | 0.65-0.80                 |
| DRILLED HOLE                | 0.81-0.86<br>(0.85 DRILL) |
| COPPER PLATING              | 0.025 MIN                 |
| SnPb PLATING                | 0.005-0.015               |

|                          |         |                |      |                                       |               |            |                |                                                             |             |
|--------------------------|---------|----------------|------|---------------------------------------|---------------|------------|----------------|-------------------------------------------------------------|-------------|
| mat'l code<br>SEE NOTE 5 |         |                |      | tolerances unless otherwise specified |               | CUSTOMER   |                | FCJ<br>www.fciconnect.com                                   |             |
| ltr                      | ecr no. | dr             | date | linear                                |               | COPY       |                | title                                                       |             |
| x                        |         |                |      | angles                                |               | projection |                | VERTICAL SIGNAL HDR 5 ROW<br>P.F. 30 POS. SPECIAL LOAD STD. |             |
|                          |         |                |      | dr                                    | K. BELL       | 2000-03-29 | product family |                                                             | METRAL 1000 |
|                          |         |                |      | enrg                                  | M. HAHN       | 2000-03-29 | code           | 213                                                         |             |
|                          |         |                |      | chr                                   | RAJKRISHNAN.V | 2009-11-13 | size           | dwg no                                                      |             |
|                          |         |                |      | appd                                  | BIJU K PAUL   | 2009-11-13 | scale          | A                                                           |             |
| sheet index              |         | revision sheet |      |                                       |               | 1:1        |                | 73983                                                       |             |
|                          |         |                |      |                                       |               |            |                | sheet 2                                                     |             |

This document is the property of and embodies CONFIDENTIAL and PROPRIETARY information of FCI. No part of the information shown on this document may be used in any way or disclosed to others without the written consent of FCI. Copyright FCI.

| PIN NO. | DIM A MATING LENGTH | DIM B TAIL LENGTH | PCB THICKNESS RANGE ACCOMMODATED BY PIN'S TAIL LENGTH |             |                                                      |             |             |
|---------|---------------------|-------------------|-------------------------------------------------------|-------------|------------------------------------------------------|-------------|-------------|
|         |                     |                   | WHEN MATING TO A 73981 OR 84688 SERIES RECEPTACLE     |             | WHEN MATING TO A 52057 SERIES METRAL 4000 RECEPTACLE |             |             |
|         |                     |                   | ROWS A,B,C,D,&E                                       | GROUND ROW  | ROWS:A,B,D&E                                         | ROW C       | GROUND ROW  |
| 01*     | 5.00                | 4.30              | 1.60 MIN                                              | 1.60 MIN    | 1.60 MIN                                             | 1.60 MIN    | 1.60 MIN    |
| 22      |                     | 12.20             | 2.95 - 3.80                                           | 2.95 - 4.20 | 2.95 - 3.80                                          | 2.95 - 3.80 | 2.95 - 4.20 |
| 30      |                     | 12.95             | 2.95 - 4.55                                           | 3.25 - 4.95 | 2.95 - 4.55                                          | 2.95 - 4.55 | 3.25 - 4.95 |
| 05      |                     | 13.70             | 2.95 - 5.30                                           | 4.00 - 5.70 | 3.30 - 5.30                                          | 2.95 - 5.30 | 4.00 - 5.70 |
| 35      |                     | 14.45             | 3.05 - 6.05                                           | 4.75 - 6.45 | 4.05 - 6.05                                          | 3.05 - 6.05 | 4.75 - 6.45 |
| 48      |                     | 15.20             | 3.80 - 6.80                                           | 5.50 - 7.20 | 4.80 - 6.80                                          | 3.80 - 6.80 | 5.50 - 7.20 |
| 40      |                     | 15.70             | 4.30 - 7.30                                           | 6.00 - 7.70 | 5.30 - 7.30                                          | 4.30 - 7.30 | 6.00 - 7.70 |
| 65      |                     | 16.40             | 5.00 - 8.00                                           | 6.70 - 8.40 | 6.00 - 8.00                                          | 5.00 - 8.00 | 6.70 - 8.40 |
| 09      |                     | 17.10             | 5.70 - 8.70                                           | 7.40 - 9.10 | 6.70 - 8.70                                          | 5.70 - 8.70 | 7.40 - 9.10 |
| 02*     | 5.75                | 4.30              | 1.60 MIN                                              | 1.60 MIN    | 1.60 MIN                                             | 1.60 MIN    | 1.60 MIN    |
| 44      |                     | 12.20             | 2.95 - 3.80                                           | 2.95 - 4.20 | 2.95 - 3.80                                          | 2.95 - 3.80 | 2.95 - 4.20 |
| 31      |                     | 12.95             | 2.95 - 4.55                                           | 3.25 - 4.95 | 2.95 - 4.55                                          | 2.95 - 4.55 | 3.25 - 4.95 |
| 06      |                     | 13.70             | 2.95 - 5.30                                           | 4.00 - 5.70 | 3.30 - 5.30                                          | 2.95 - 5.30 | 4.00 - 5.70 |
| 36      |                     | 14.45             | 3.05 - 6.05                                           | 4.75 - 6.45 | 4.05 - 6.05                                          | 3.05 - 6.05 | 4.75 - 6.45 |
| 49      |                     | 15.20             | 3.80 - 6.80                                           | 5.50 - 7.20 | 4.80 - 6.80                                          | 3.80 - 6.80 | 5.50 - 7.20 |
| 25      |                     | 15.70             | 4.30 - 7.30                                           | 6.00 - 7.70 | 5.30 - 7.30                                          | 4.30 - 7.30 | 6.00 - 7.70 |
| 66      |                     | 16.40             | 5.00 - 8.00                                           | 6.70 - 8.40 | 6.00 - 8.00                                          | 5.00 - 8.00 | 6.70 - 8.40 |
| 10      |                     | 17.10             | 5.70 - 8.70                                           | 7.40 - 9.10 | 6.70 - 8.70                                          | 5.70 - 8.70 | 7.40 - 9.10 |
| 03*     | 6.50                | 4.30              | 1.60 MIN                                              | 1.60 MIN    | 1.60 MIN                                             | 1.60 MIN    | 1.60 MIN    |
| 45      |                     | 12.20             | 2.95 - 3.80                                           | 2.95 - 4.20 | 2.95 - 3.80                                          | 2.95 - 3.80 | 2.95 - 4.20 |
| 32      |                     | 12.95             | 2.95 - 4.55                                           | 3.25 - 4.95 | 2.95 - 4.55                                          | 2.95 - 4.55 | 3.25 - 4.95 |
| 07      |                     | 13.70             | 2.95 - 5.30                                           | 4.00 - 5.70 | 3.30 - 5.30                                          | 2.95 - 5.30 | 4.00 - 5.70 |
| 37      |                     | 14.45             | 3.05 - 6.05                                           | 4.75 - 6.45 | 4.05 - 6.05                                          | 3.05 - 6.05 | 4.75 - 6.45 |
| 50      |                     | 15.20             | 3.80 - 6.80                                           | 5.50 - 7.20 | 4.80 - 6.80                                          | 3.80 - 6.80 | 5.50 - 7.20 |
| 41      |                     | 15.70             | 4.30 - 7.30                                           | 6.00 - 7.70 | 5.30 - 7.30                                          | 4.30 - 7.30 | 6.00 - 7.70 |
| 24      |                     | 16.40             | 5.00 - 8.00                                           | 6.70 - 8.40 | 6.00 - 8.00                                          | 5.00 - 8.00 | 6.70 - 8.40 |
| 11      |                     | 17.10             | 5.70 - 8.70                                           | 7.40 - 9.10 | 6.70 - 8.70                                          | 5.70 - 8.70 | 7.40 - 9.10 |



This document is the property of and embodies CONFIDENTIAL and PROPRIETARY information of FCI. No part of the information shown on this document may be used in any way or disclosed to others without the written consent of FCI. Copyright FCI.

|                          |                |    |      |                                       |                                                                                                                 |  |          |                                                                      |                    |             |  |
|--------------------------|----------------|----|------|---------------------------------------|-----------------------------------------------------------------------------------------------------------------|--|----------|----------------------------------------------------------------------|--------------------|-------------|--|
| mat'l code<br>SEE NOTE 5 |                |    |      | tolerances unless otherwise specified |                                                                                                                 |  | CUSTOMER |                                                                      | www.fciconnect.com |             |  |
| ltr                      | ecn no.        | dr | date | linear                                | projection<br>                                                                                                  |  |          | title<br>VERTICAL SIGNAL HDR 5 ROW<br>P.F. 30 POS. SPECIAL LOAD STD. |                    |             |  |
| X                        |                |    |      |                                       |                                                                                                                 |  |          |                                                                      |                    |             |  |
|                          |                |    |      |                                       |                                                                                                                 |  |          |                                                                      |                    |             |  |
|                          |                |    |      | angles                                | dr K. BELL 2000-03-29<br>engr M. HAHN 2000-03-29<br>chr RAJKRISHNAN.V 2009-11-13<br>appd BIJU K PAUL 2009-11-13 |  |          | product family<br>size dwg no<br>A 73983                             |                    | code<br>213 |  |
|                          |                |    |      |                                       |                                                                                                                 |  |          | scale<br>1:1                                                         |                    | sheet<br>3  |  |
|                          |                |    |      |                                       |                                                                                                                 |  |          |                                                                      |                    |             |  |
| sheet index              | revision sheet |    |      |                                       |                                                                                                                 |  |          |                                                                      |                    |             |  |

| PIN NO. | DIM A MATING LENGTH | DIM B TAIL LENGTH | PCB THICKNESS RANGE ACCOMMODATED BY PIN LENGTH    |             |                                                      |             |             |
|---------|---------------------|-------------------|---------------------------------------------------|-------------|------------------------------------------------------|-------------|-------------|
|         |                     |                   | WHEN MATING TO A 73981 OR 84688 SERIES RECEPTACLE |             | WHEN MATING TO A 52057 SERIES METRAL 4000 RECEPTACLE |             |             |
|         |                     |                   | ROWS A,B,C,D,&E                                   | GROUND ROW  | ROWS:A,B,D&E                                         | ROW C       | GROUND ROW  |
| 04*     | 7.25                | 4.30              | 1.60 MIN                                          | 1.60 MIN    | 1.60 MIN                                             | 1.60 MIN    | 1.60 MIN    |
| 46      |                     | 12.20             | 2.95 - 3.80                                       | 2.95 - 4.20 | 2.95 - 3.80                                          | 2.95 - 3.80 | 2.95 - 4.20 |
| 33      |                     | 12.95             | 2.95 - 4.55                                       | 3.25 - 4.95 | 2.95 - 4.55                                          | 2.95 - 4.55 | 3.25 - 4.95 |
| 08      |                     | 13.70             | 2.95 - 5.30                                       | 4.00 - 5.70 | 3.30 - 5.30                                          | 2.95 - 5.30 | 4.00 - 5.70 |
| 38      |                     | 14.45             | 3.05 - 6.05                                       | 4.75 - 6.45 | 4.05 - 6.05                                          | 3.05 - 6.05 | 4.75 - 6.45 |
| 51      |                     | 15.20             | 3.80 - 6.80                                       | 5.50 - 7.20 | 4.80 - 6.80                                          | 3.80 - 6.80 | 5.50 - 7.20 |
| 42      |                     | 15.70             | 4.30 - 7.30                                       | 6.00 - 7.70 | 5.30 - 7.30                                          | 4.30 - 7.30 | 6.00 - 7.70 |
| 67      |                     | 16.40             | 5.00 - 8.00                                       | 6.70 - 8.40 | 6.00 - 8.00                                          | 5.00 - 8.00 | 6.70 - 8.40 |
| 12      |                     | 17.10             | 5.70 - 8.70                                       | 7.40 - 9.10 | 6.70 - 8.70                                          | 5.70 - 8.70 | 7.40 - 9.10 |
| 19*     | 8.00                | 4.30              | 1.60 MIN                                          | 1.60 MIN    | 1.60 MIN                                             | 1.60 MIN    | 1.60 MIN    |
| 47      |                     | 12.20             | 2.95 - 3.80                                       | 2.95 - 4.20 | 2.95 - 3.80                                          | 2.95 - 3.80 | 2.95 - 4.20 |
| 34      |                     | 12.95             | 2.95 - 4.55                                       | 3.25 - 4.95 | 2.95 - 4.55                                          | 2.95 - 4.55 | 3.25 - 4.95 |
| 20      |                     | 13.70             | 2.95 - 5.30                                       | 4.00 - 5.70 | 3.30 - 5.30                                          | 2.95 - 5.30 | 4.00 - 5.70 |
| 39      |                     | 14.45             | 3.05 - 6.05                                       | 4.75 - 6.45 | 4.05 - 6.05                                          | 3.05 - 6.05 | 4.75 - 6.45 |
| 52      |                     | 15.20             | 3.80 - 6.80                                       | 5.50 - 7.20 | 4.80 - 6.80                                          | 3.80 - 6.80 | 5.50 - 7.20 |
| 43      |                     | 15.70             | 4.30 - 7.30                                       | 6.00 - 7.70 | 5.30 - 7.30                                          | 4.30 - 7.30 | 6.00 - 7.70 |
| 68      |                     | 16.40             | 5.00 - 8.00                                       | 6.70 - 8.40 | 6.00 - 8.00                                          | 5.00 - 8.00 | 6.70 - 8.40 |
| 21      |                     | 17.10             | 5.70 - 8.70                                       | 7.40 - 9.10 | 6.70 - 8.70                                          | 5.70 - 8.70 | 7.40 - 9.10 |



This document is the property of and embodies CONFIDENTIAL and PROPRIETARY information of FCI. No part of the information shown on this document may be used in any way or disclosed to others without the written consent of FCI. Copyright FCI.

|             |                |            |      |                                       |               |            |           |                                                                   |        |
|-------------|----------------|------------|------|---------------------------------------|---------------|------------|-----------|-------------------------------------------------------------------|--------|
| mat'l code  |                | SEE NOTE 5 |      | tolerances unless otherwise specified |               | CUSTOMER   |           | www.fciconnect.com                                                |        |
| ltr         | ecr no.        | dr         | date | linear                                | projection    |            |           |                                                                   |        |
| x           |                |            |      |                                       | angles        |            |           | title VERTICAL SIGNAL HDR 5 ROW<br>P.F. 30 POS. SPECIAL LOAD STD. |        |
|             |                |            |      | dr                                    | K. BELL       | 2000-03-29 | MM        | product family METRAL 1000                                        |        |
|             |                |            |      | enr                                   | M. HAHN       | 2000-03-29 |           | code                                                              | 213    |
|             |                |            |      | chr                                   | RAJKRISHNAN.V | 2009-11-13 | scale 1:1 | size                                                              | dwg no |
|             |                |            |      | appd                                  | BIJU K PAUL   | 2009-11-13 |           | A                                                                 | 73983  |
| sheet index | revision sheet |            |      |                                       |               |            |           |                                                                   |        |



This document is the property of and embodies  
 CONFIDENTIAL and PROPRIETARY information of FCJ.  
 No part of the information shown on this  
 document may be used in any way or disclosed  
 to others without the written consent of FCJ.  
 Copyright FCJ.

| SPECIAL LOAD PATTERNS                                        |     |           |
|--------------------------------------------------------------|-----|-----------|
| PRODUCT #                                                    | ROW | PIN CODES |
| 73983-X001<br><br>SEE NOTE 14<br>LEAD FREE<br>OPTION         | E   | 01        |
|                                                              | D   |           |
|                                                              | C   |           |
|                                                              | B   |           |
|                                                              | A   |           |
|                                                              | GND |           |
| 73983-X002<br>*RPU<br><br>SEE NOTE 14<br>LEAD FREE<br>OPTION | E   | 22        |
|                                                              | D   |           |
|                                                              | C   |           |
|                                                              | B   |           |
|                                                              | A   |           |
|                                                              | GND |           |
| 73983-X003<br>*RPU<br><br>SEE NOTE 14<br>LEAD FREE<br>OPTION | E   | 30        |
|                                                              | D   |           |
|                                                              | C   |           |
|                                                              | B   |           |
|                                                              | A   |           |
|                                                              | GND |           |
| 73983-X004<br>*RPU<br><br>SEE NOTE 14<br>LEAD FREE<br>OPTION | E   | 05        |
|                                                              | E   |           |
|                                                              | C   |           |
|                                                              | B   |           |
|                                                              | A   |           |
|                                                              | GND |           |

PCB THICKNESS  
RANGE FOR REAR  
PLUG UP  
APPLICATIONS  
2.95 TO 3.80mm

PCB THICKNESS  
RANGE FOR REAR  
PLUG UP  
APPLICATIONS  
3.25 TO 4.55mm

PCB THICKNESS  
RANGE FOR REAR  
PLUG UP  
APPLICATIONS  
4.00 TO 5.30mm

\* REAR PLUG UP PART NUMBER

| SPECIAL LOAD PATTERNS                                        |     |           |
|--------------------------------------------------------------|-----|-----------|
| PRODUCT #                                                    | ROW | PIN CODES |
| 73983-X005<br>*RPU<br><br>SEE NOTE 14<br>LEAD FREE<br>OPTION | E   | 35        |
|                                                              | D   |           |
|                                                              | C   |           |
|                                                              | B   |           |
|                                                              | A   |           |
|                                                              | GND |           |
| 73983-X008<br>*RPU<br><br>SEE NOTE 14<br>LEAD FREE<br>OPTION | E   | 09        |
|                                                              | D   |           |
|                                                              | C   |           |
|                                                              | B   |           |
|                                                              | A   |           |
|                                                              | GND |           |
| 73983-X011<br><br>SEE NOTE 14<br>LEAD FREE<br>OPTION         | E   | 02        |
|                                                              | D   |           |
|                                                              | C   |           |
|                                                              | B   |           |
|                                                              | A   |           |
|                                                              | GND |           |
| 73983-X012<br>*RPU<br><br>SEE NOTE 14<br>LEAD FREE<br>OPTION | E   | 44        |
|                                                              | D   |           |
|                                                              | C   |           |
|                                                              | B   |           |
|                                                              | A   |           |
|                                                              | GND |           |

PCB THICKNESS  
RANGE FOR REAR  
PLUG UP  
APPLICATIONS  
4.75 TO 6.05mm

PCB THICKNESS  
RANGE FOR REAR  
PLUG UP  
APPLICATIONS  
7.40 TO 8.70mm

PCB THICKNESS  
RANGE FOR REAR  
PLUG UP  
APPLICATIONS  
2.95 TO 3.80mm

|                       |                |    |      |                                       |               |            |           |                                                             |                           |  |
|-----------------------|----------------|----|------|---------------------------------------|---------------|------------|-----------|-------------------------------------------------------------|---------------------------|--|
| mat'l code SEE NOTE 5 |                |    |      | tolerances unless otherwise specified |               |            | CUSTOMER  |                                                             | FCJ<br>www.fcjconnect.com |  |
| ltr                   | ecr no.        | dr | date | linear                                | projection    |            |           | title                                                       |                           |  |
| x                     |                |    |      |                                       | MM            |            |           | VERTICAL SIGNAL HDR 5 ROW<br>P.F. 30 POS. SPECIAL LOAD STD. |                           |  |
|                       |                |    |      |                                       | angles        |            |           | product family METRAL 1000 code                             |                           |  |
|                       |                |    |      | dr                                    | K. BELL       | 2000-03-29 | size      |                                                             | 213                       |  |
|                       |                |    |      | enr                                   | M. HAHN       | 2000-03-29 | dwg no    |                                                             | 5                         |  |
|                       |                |    |      | chr                                   | RAJKRISHNAN.V | 2009-11-13 | A         |                                                             | 73983                     |  |
|                       |                |    |      | appd                                  | BIJU K PAUL   | 2009-11-13 | scale 1:1 |                                                             | sheet                     |  |
| sheet index           | revision sheet |    |      |                                       |               |            |           |                                                             |                           |  |



This document is the property of and embodies CONFIDENTIAL and PROPRIETARY information of FCI. No part of the information shown on this document may be used in any way or disclosed to others without the written consent of FCI. Copyright FCI.

| SPECIAL LOAD PATTERNS                                |     |           | PRODUCT #                                                      | ROW | COLUMN |    |    |    |    |    |
|------------------------------------------------------|-----|-----------|----------------------------------------------------------------|-----|--------|----|----|----|----|----|
| PRODUCT #                                            | ROW | PIN CODES |                                                                |     | 1      | 2  | 3  | 4  | 5  | 6  |
| 73983-X021<br><br>SEE NOTE 14<br>LEAD FREE<br>OPTION | E   | 01        | 73983-X033<br><br>SEE NOTE 14<br>LEAD FREE<br>OPTION           | E   | 02     | 02 | 02 | 02 | 02 | 02 |
|                                                      | D   |           |                                                                | 02  | 02     | 02 | 02 | 02 | 02 |    |
|                                                      | C   | 03        |                                                                | C   | 02     | 02 | 02 | 02 | 01 | 02 |
|                                                      | B   | 01        |                                                                | B   | 02     | 02 | 02 | 02 | 02 | 02 |
|                                                      | A   |           |                                                                | A   | 02     | 02 | 02 | 02 | 02 | 02 |
|                                                      | GND |           |                                                                | GND | 02     | 02 | 02 | 02 | 02 | 02 |
| 73983-X031<br><br>SEE NOTE 14<br>LEAD FREE<br>OPTION | E   | 03        | 73983-X032<br><br>**<br><br>SEE NOTE 14<br>LEAD FREE<br>OPTION | E   | 01     | 19 | E  | 01 | 19 | 01 |
|                                                      | D   |           |                                                                | D   |        |    |    |    |    |    |
|                                                      | C   |           |                                                                | C   |        |    |    |    |    |    |
|                                                      | B   |           |                                                                | B   |        |    |    |    |    |    |
|                                                      | A   |           |                                                                | A   |        |    |    |    |    |    |
| GND                                                  | GND |           |                                                                |     |        |    |    |    |    |    |

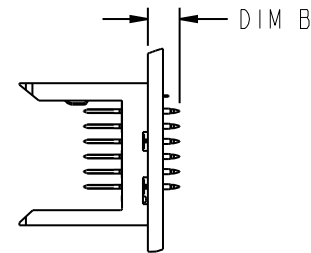
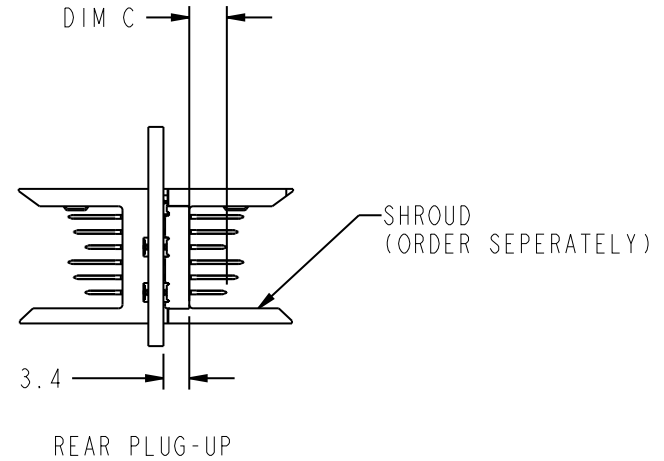

|                          |                |    |      |                                       |               |            |            |          |                                                                      |                           |        |
|--------------------------|----------------|----|------|---------------------------------------|---------------|------------|------------|----------|----------------------------------------------------------------------|---------------------------|--------|
| mat'l code<br>SEE NOTE 5 |                |    |      | tolerances unless otherwise specified |               |            |            | CUSTOMER |                                                                      | FCI<br>www.fciconnect.com |        |
| ltr                      | ecr no.        | dr | date | linear                                | projection    |            |            |          | title<br>VERTICAL SIGNAL HDR 5 ROW<br>P.F. 30 POS. SPECIAL LOAD STD. |                           |        |
| X                        |                |    |      |                                       | angles        |            |            |          | product family METRAL 1000 code 213                                  |                           |        |
|                          |                |    |      |                                       | dr            | K. BELL    | 2000-03-29 | MM       |                                                                      | size                      | dwg no |
|                          |                |    |      | enr                                   | M. HAHN       | 2000-03-29 | 1:1        |          | A                                                                    | 73983                     | 6      |
|                          |                |    |      | chr                                   | RAJKRISHNAN.V | 2009-11-13 | scale      |          |                                                                      |                           |        |
|                          |                |    |      | appd                                  | BIJU K PAUL   | 2009-11-13 |            |          |                                                                      |                           |        |
| sheet index              | revision sheet |    |      |                                       |               |            |            |          |                                                                      |                           |        |

\*\* CANNOT BE MATED TO A METRAL 4000 RECEPTACLE